

Basic Instructions only!
For more detailed product information, refer to the
Rehearsal Resource Center Assembly Instructions 121B021.

⚠ CAUTION

Make sure anyone assembling, installing or using this product has read and understands these instructions.

⚠ CAUTION

Failure to comply with Warnings and Cautions in this document or on the equipment can result in damage to property or injury.

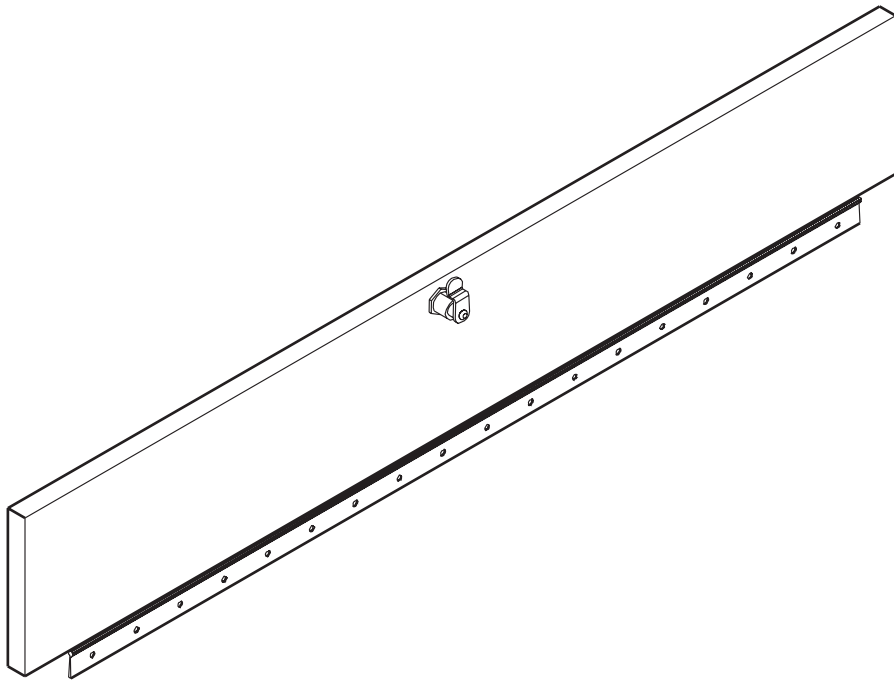

Contents

Required Tools	2	Parts List	2
Supplied Hardware	2	Assembly	2



Visit the Rehearsal Resource Center web page at wengercorp.com for more information.

Note: Please read and understand these instructions before proceeding.
Note: If you need additional information, contact Wenger Corporation using the information below.

Required Tools

The use of a power driver is not recommended.

- Mallet
- Phillips screwdriver
- Short phillips screwdriver
- 5/8" and 7/8" open end wrench (adjustable wrench is optional)

Supplied Hardware

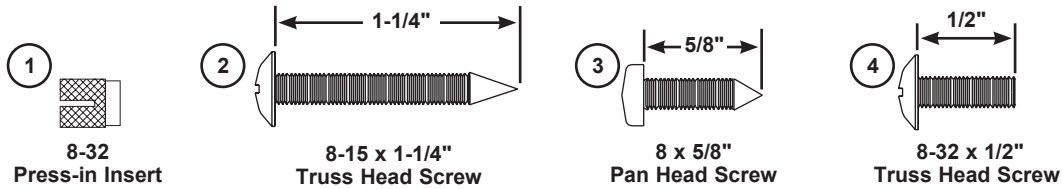

Parts List

Item	Description	Item	Description
1	8-32 Press-in Insert	5	Hinge
2	8-15 x 1-1/4" Truss Head Screw	6	Upper Lock Door
3	8 x 5/8" Pan Head Screw	7	Lock Bracket
4	8-32 x 1/2" Truss Head Screw	8	Lock Assembly
		9	Off-Set Cam Lock

Assembly

Before starting the upper lock door option assembly, do the following:

1. Read and understand this assembly instruction.
2. Remove all items from the shipping cartons. Make sure that all parts are present. Item numbers refer to the parts list above.
3. Inventory the hardware package and make sure that all required hardware is present. Discard any items not used during the assembly.

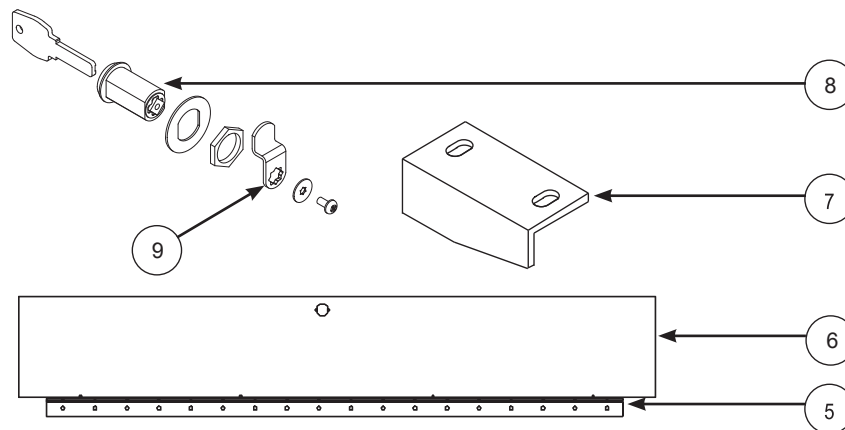

Assembly (continued)

1. Attach the hinge (5) to the upper lock door (6).
 - a. Lay the upper lock door (6) on a horizontal surface with the upper lock door hole offset toward the curved end of the unit assembly. The outside surface is up.

NOTICE

To install the optional upper lock door on a drawer unit assembly, make sure that the pilot holes are facing down and the lock hole is offset to the right, as shown below. The lock hole is offset to the left on a left curved unit assembly.

- b. Align the hinge (5) to the pilot holes on the bottom edge of the upper lock door (6) as shown below. **Make sure that the barrel of the hinge (5) faces away from the bottom edge of the upper lock door (6) and that the screws do not align with screw holes used to mount the door to the unit assembly.**
- c. Using a phillips screwdriver, screw four truss head screws (2) through the clearance holes in the hinge (5) into the four upper lock door pilot holes (6).

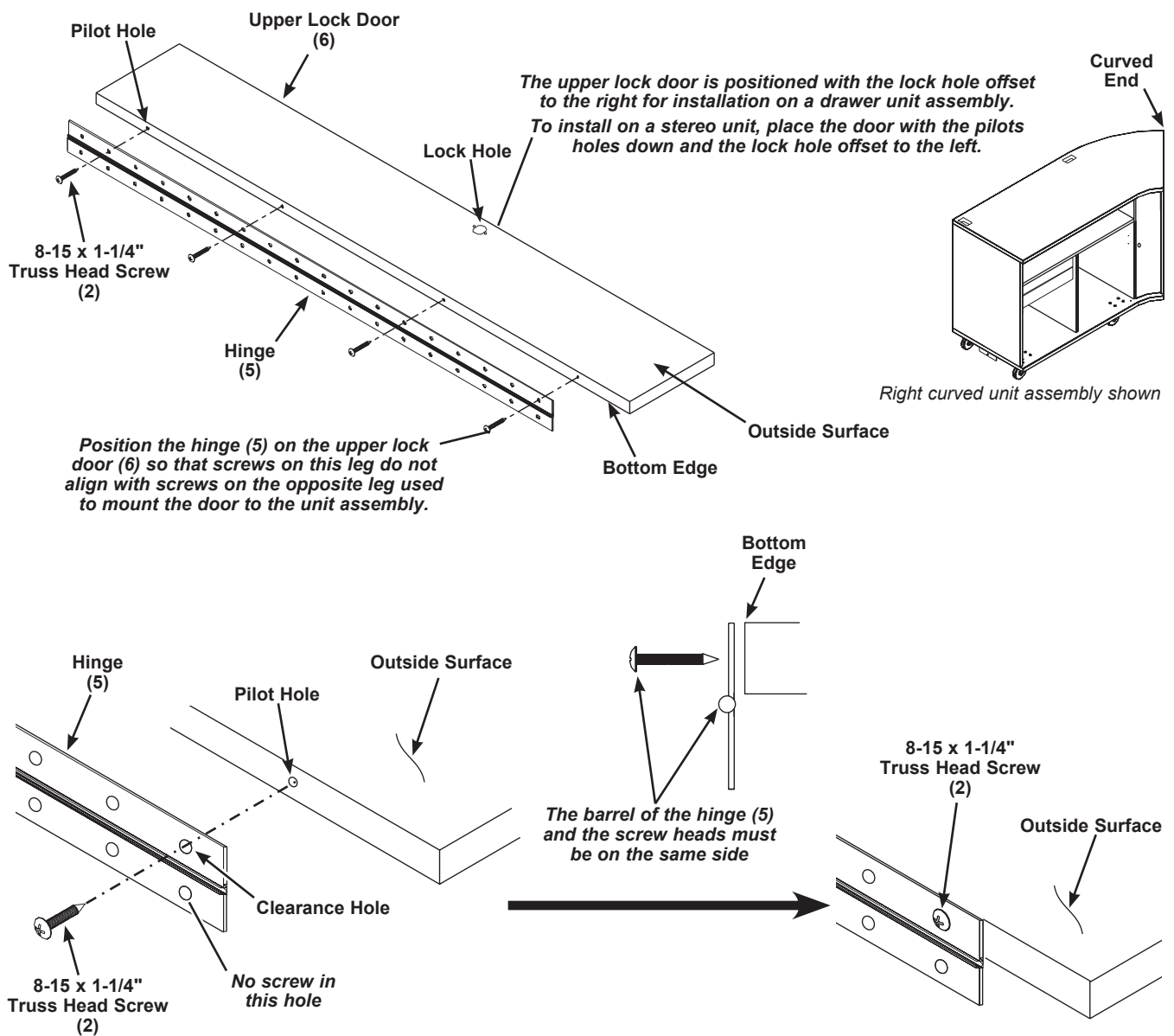

Assembly (continued)

2. Assemble the lock assembly (8) to the upper lock door (6).
 - a. Position the lock housing so that the flat sides are parallel with the sides of the upper lock door (6).
 - b. Insert the lock housing into the outside of the upper lock door hole (6).
 - c. On the inside surface of the door, slide the locking thrust washer over the end of the lock housing.
 - d. Fasten the hex nut to the lock housing. Do not allow the lock housing to rotate.
 - e. Hold the threaded end of the lock with a 5/8" open end wrench and tighten the hex nut with a 7/8" open end wrench or adjustable wrench.

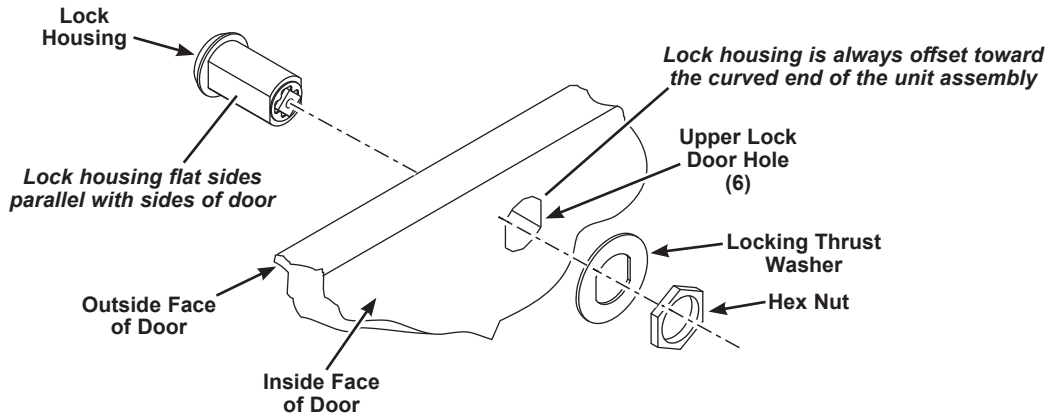

3. Assemble the offset cam to the door lock assembly.
 - a. Slide the offset cam onto the end of the lock assembly.
 - b. Slide the washer onto the end of the lock assembly.
 - c. Fasten the machine screw to the end of the lock assembly and tighten.
 - d. Insert the key and make sure that turning the key clockwise rotates the offset cam to the vertical position as shown below. If the offset cam is not vertical, loosen the machine screw and reposition the offset cam. Then tighten the machine screw.

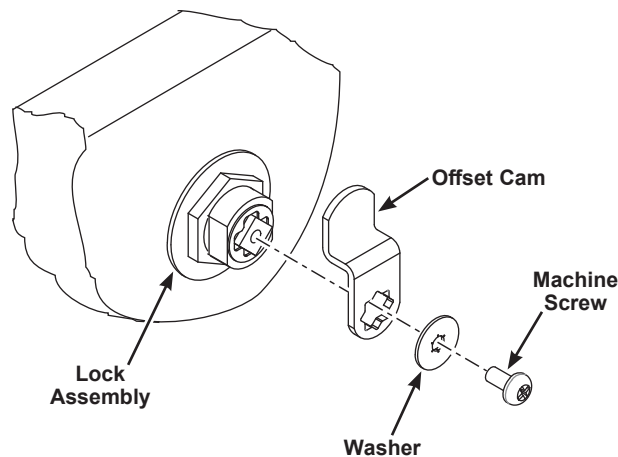

Assembly (continued)

4. Using the mallet, tap five brass press-in inserts (1) into the pilot holes in the mid-shelf (slotted end enters pilot hole first). Pinch the slotted end together with pliers to make it easier to engage the hole.

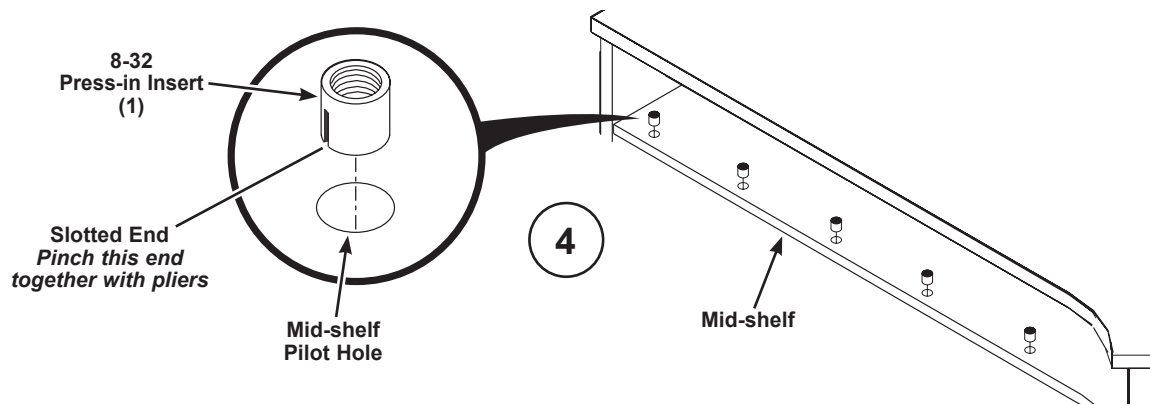

Assembly (continued)

- Attach the lock bracket (7) with two pan head screws (3) to the pair of pilot holes on the underneath side of the unit top panel. **The lock bracket (7) may require adjustment for the offset cam to engage the lock bracket.**
- Use five pan head screws (3) and attach the upper lock door to the unit assembly as shown in the illustration below. Make sure that screws on the opposite leg of the hinge are offset so that the hinge can fold 180°.
- Insert the key into the lock assembly and turn it counterclockwise (unlocking the lock).
- Close the door and turn the key clockwise (locking the door). The door will not stay closed unless it is locked.

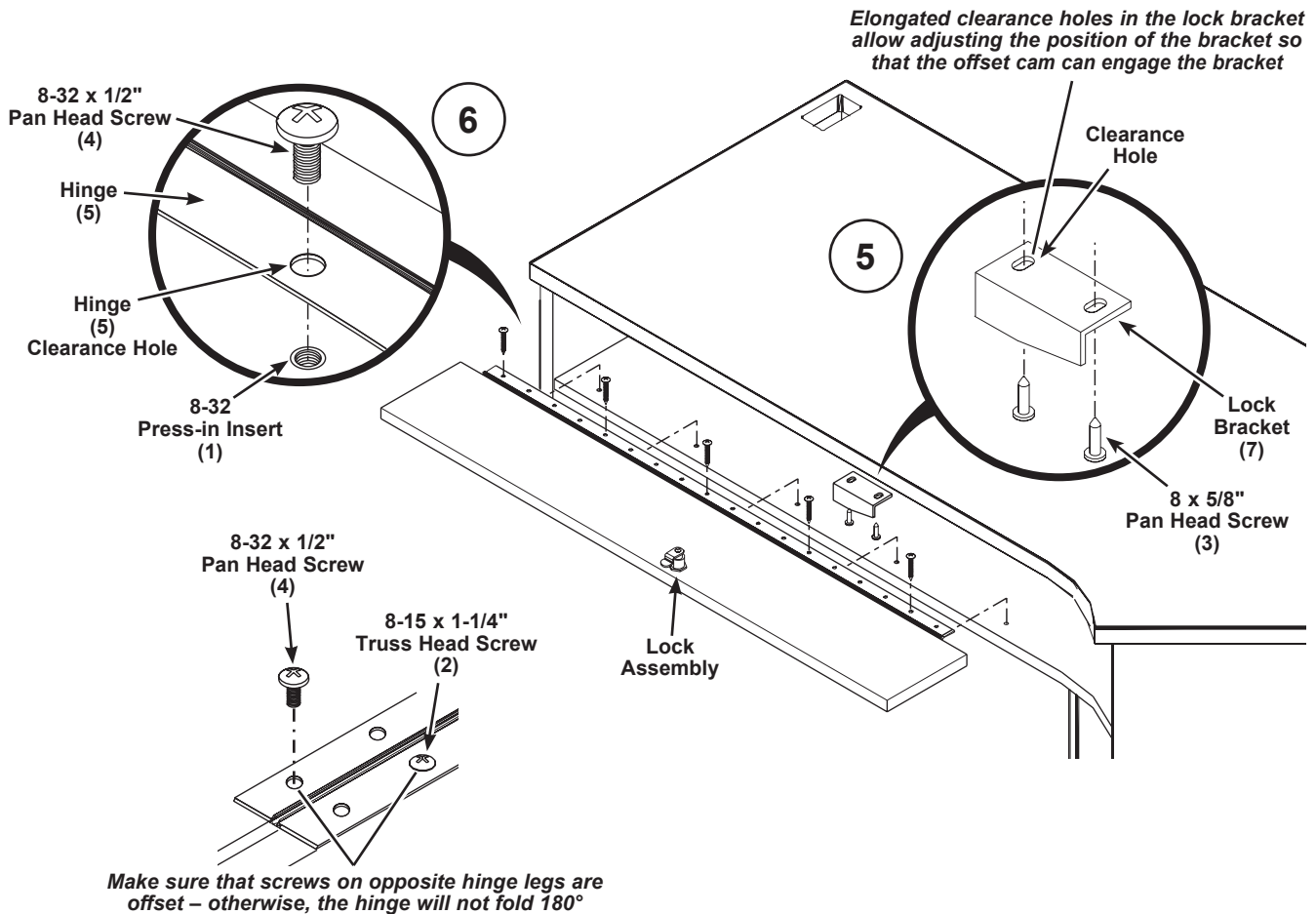

This page is intentionally blank.

This page is intentionally blank.